

BSPTB-GC

PN20

DN6~15

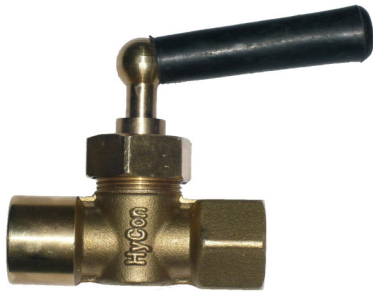

SPECIFICATION

FULL BORE · PTFE SEAT

THREADED TO BSP

SIZE RANGE 6mm (1/4")~ 15mm (1/2")

PRESSURE / TEMPERATURE RATINGS

Working Pressure	300 psi (20.7 bar) Water Non-Shock
Testing Pressure	Shell : 450 psi (31 bar) Hydrostatic Seat : 330 psi (22.7 bar) Hydrostatic 80 psi (5.5 bar) Air

MATERIALS

Part	Material	ASTM	BS
Body	Brass	B124 C37700	2874 CZ122
Stem	Brass	B124 C37000	2874 CZ121
Ball	Brass (Chrome Plated)	B124 C37700	2874 CZ122
Seat	PTFE		

DIMENSIONS

Size		L		H		D	
mm	inch	mm	inch	mm	inch	mm	inch
6	1/4	44	1.73	18	0.70	37	1.46
10	3/8	55	2.16	22	0.87	37	1.46
15	1/2	60	2.36	27	1.06	54	2.13

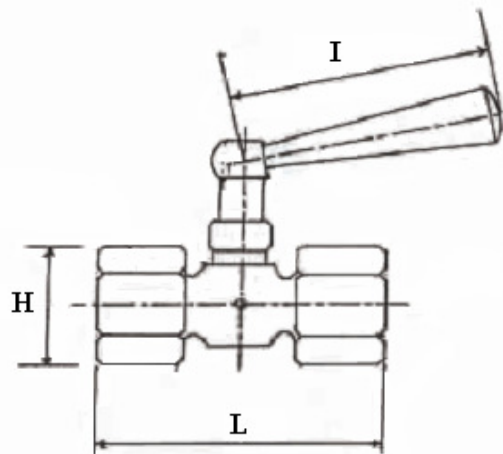

Note:

1. Other materials and threaded standards are available upon request.
2. Design and specifications are subject to change without prior notice.